



Shower - LISSÉ

Concealed thermostat with two-way volume control - Black matte

Article number: 36 426 845-33 0010

Date of manufacture from 2/2/2021



- Diverter with integrated volume control
- Cover plate 5-7/8" x 3-1/2"
- Temperature control handle with safety lock at 100 °F/ 38°C
- Max. temperature can be set on the trim

Codes & Standards

- ASME A112.18.1/CSA B125.1
- ADA

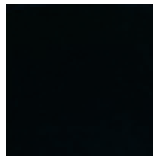

Black matte



Shower - LISSÉ

Concealed thermostat with two-way volume control - Black matte

Article number: 36 426 845-33 0010

Date of manufacture from 2/2/2021

Dimensional drawing

mm [inches]

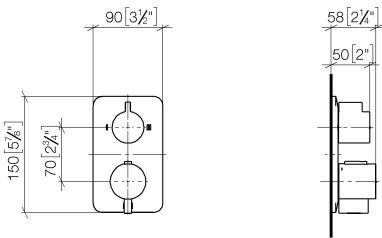

All dimensions in mm / inch = mm x 0,0394

Flow rate chart

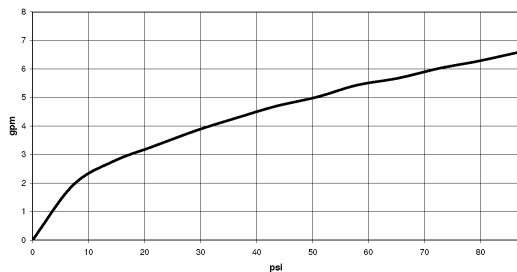



Shower - LISSÉ

Concealed thermostat with two-way volume control - Black matte

Article number: 36 426 845-33 0010

Date of manufacture from 2/2/2021

Other surface finishes



Chrome

36 426 845-00 0010



Brushed Platinum

36 426 845-06 0010



Brushed Chrome

36 426 845-93 0010

More custom finish options are available via special production (xTra Service). See our finish matrix for availability and pricing or contact a Dornbracht representative. Some series may be excluded and some finishes may not be available in all series.

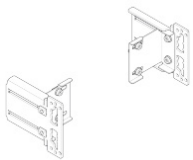

12 340 970 90

xGRID Mounting bracket for
drywall construction -

Shower - LISSÉ

Concealed thermostat with two-way volume control - Black matte

Article number: 36 426 845-33 0010

Date of manufacture from 2/2/2021

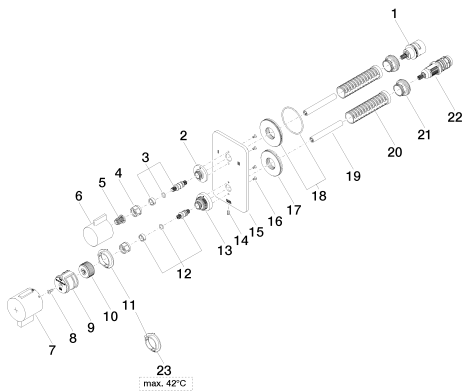

Spare parts list

Number	Item Number	Designation	Number of units
1	90 90 03 163 00 90	diverter	1
2	09 12 12 053-33	base	1
3	04 29 06 111 00-00	spindle	1
4	09 23 30 023 90	nut	2
5	90 12 12 002 00 90	fixing cap	1
6	09 20 67 006-33	handle	1
7	90 17 33 019 00-33	handle	1
8	09 30 30 124 90	screw	1
9	09 12 12 052 90	base	1
10	09 12 12 054 90	base	1
11	09 28 10 190 90	regulator	1
12	04 29 06 024 00-00	spindle	1
13	09 12 12 051-33	base	1
14	09 31 11 134 90	pin	1
15	09 11 02 304-33	plate	1
16	09 30 30 157 90	screw	4
17	09 30 01 296 90	disc	1
18	90 30 01 190 00 90	disc	1
19	09 23 01 124 90	sleeve	2
20	09 18 40 077 90	sleeve	2
21	09 24 04 257 90	nut	2
22	90 15 02 013 00 90	cartridge	1
23	09 28 10 189 90	regulator	1