

# KA 38 Specifications

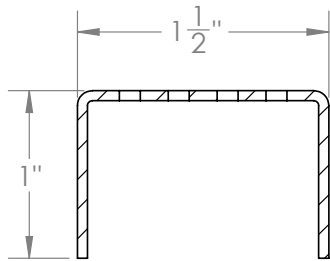

**KA 38:**  
- Offset slotted perforated grate for S-LT 38  
- 16 gauge, 304L stainless steel

**Models (overall dimensions):**  
- KA 3836: 35 7/8" L x 1 1/2" W x 1" H  
- KA 3848: 47 7/8" L x 1 1/2" W x 1" H  
- KA 3860: 59 7/8" L x 1 1/2" W x 1" H  
- KA 3872: 71 7/8" L x 1 1/2" W x 1" H  
- KA 3896: 95 7/8" L x 1 1/2" W x 1" H

**Finishes:**  
- Satin Stainless - SS  
- Polished Stainless - PS  
- Satin Bronze - SB  
- Oil Rubbed Bronze - ORB  
- Matte Black - BK

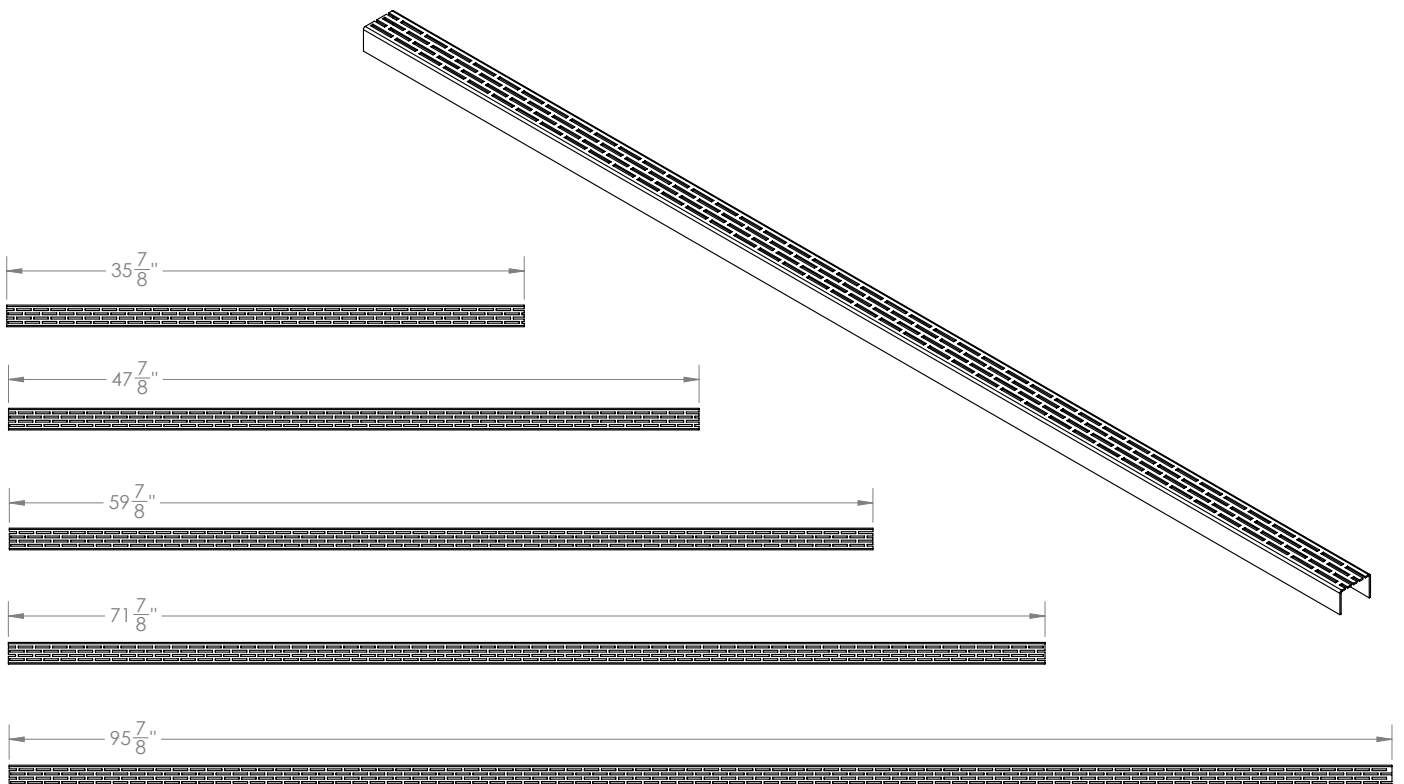

**Infinity Drain**  
145 Dixon Avenue  
Amityville, NY 11701  
Phone: 516.767.6786  
Fax: 516.740.3066  
www.infinitydrain.com



NOTE: Installer must verify all rough-in dimensions prior to installation and consult local and national codes. Conformity and compliance to local and national codes are the responsibility of the installer.